

PRO-KOLD

SPEC SHEETS

MODEL: VC43 PKD

GLASS DOOR REFRIGERATOR

Product Features

- Easy access to the engine for cleaning
- Double glass door, offers greater insulation and resistance which helps optimize the use of energy
- Your food always fresh and at the ideal temperature
- Advertising display
You can place promotions of your business to increase your sales
- Door with self closing
- Automatic / night mode, helps reduce energy consumption
- Stainless steel floor, much more hygienic and easy to clean
- Best exhibition thanks to its adjustable grills
- LED lighting inside the refrigerator
- Coolant friendly to the environment

Accessories

- Gravity kits, sandwich trays and freezer baskets
- Casters and leveling leg
- Preparation for heavy duty wheels for easy displacement (sold as accessory does not include installation)

Product highlights



Stainless steel floor



Adjustable grills



Space for advertising

Certifications



Warranty

- 2 Years Parts and labor
- 3 Years compressor coverage

Residential: Assumes on liability for parts or labor coverage for component failure, factory defect or any other damages for units installed in non-commercial foodservice or residential applications.



PRODUCT SPECIFICATIONS

MODEL: VC43 PKD



Plan view

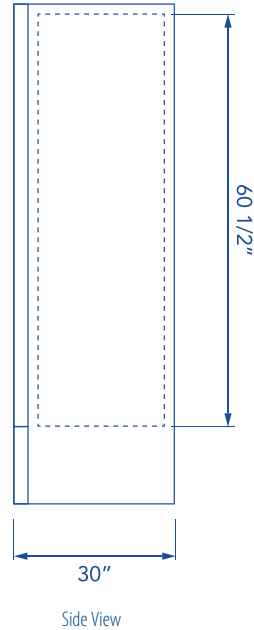
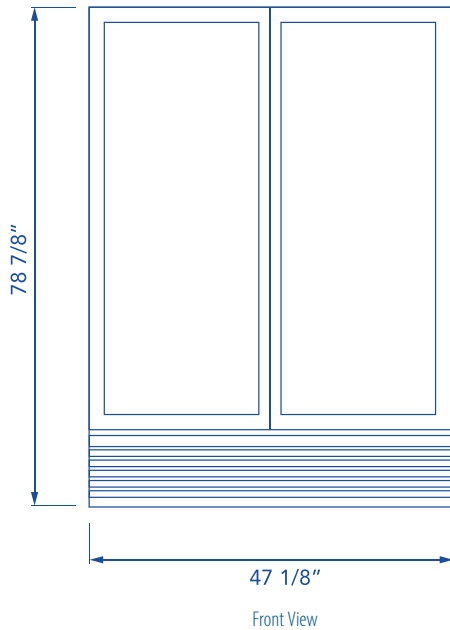

Technical data

Dimensions

External Dimensions	H 78 1/3" W 47" D 29 2/3"
Internal Dimensions	H 60 5/9" W 43" D 24 1/2"
Usable Internal	H 54 4/7" W 42 3/4" D 21"
Net volume	23.81 ft ³ 674.32 lts
Gross weight	430.78 Lbs.
Packging dimensions	H 81 1/8" W 48 1/4" D 30 3/4"

Performance data

Refrigerant charge	3.17 oz
Energy consumption	3.12 kwh/24h
Compressor power	1/3 hp
Condenser	Finless
Evaporator	Dynamic
Thermostat Setting	Cut-out 32F 0C Cut-out 44.6F 7C

Construction

Exterior material	Coated steel
Interior material	Aluminum
Door type	Glass sliding

Electrical data

Power supply	115v/ 60 Hz
Amps	7.3
Cord d Length	118" 3000 mm
Lighting	180 LUX 4 modules 18 LED per module
Plug type	NEMA 5-15P
Controller	ERC

Cooling

Temperature range	33°F - 40°F
Refrigerant	R290
Max. ambient temperature	90° F
Defrosting	Automatic
Temperature controller	Digital
Horsepower	1/3

Logistic data

Trailer Loads	53':38 40':28
Unit Weight with packaging	440.92 lb 200 kg
Dimensions with packaging	H 82 1/6" W 47 3/5" D 30 1/6"

* L= Length, D= Depth, H= Height

* TBD= to be define