

# USER MANUAL

## Model: MEAT DISPLAY

**PRO-KOLD**

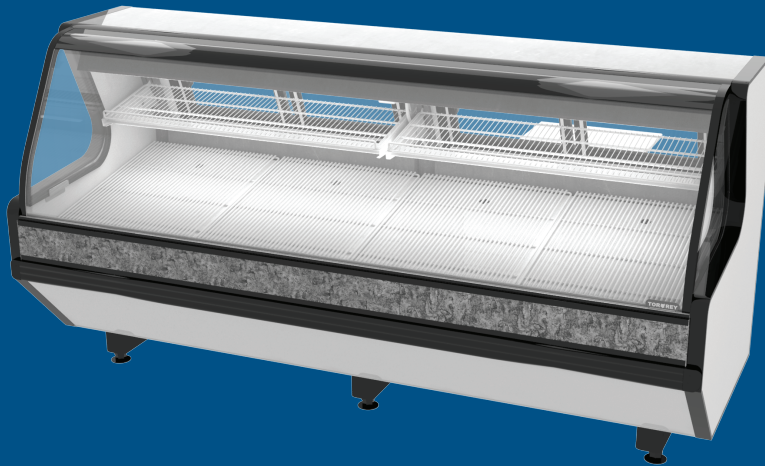

## MEAT DISPLAY

- ◉ Use and care manual for HC refrigerant gas cooler

\*IMAGES FOR ILLUSTRATION PURPOSES ONLY

Included lines: INCLUDES LINES TVC

3058415R01

Carefully read this manual before  
using cooler



# USER MANUAL

## CONTENT

**PRO-KOLD**

|  |           |
|--|-----------|
| <b>INTRODUCTION</b>  | <b>3</b>  |
| <b>SPECIFICATIONS</b>  | <b>3</b>  |
| <b>WARNINGS</b>  | <b>3</b>  |
| <b>KNOWING YOUR EQUIPMENT</b>  | <b>4</b>  |
| <b>INSTALLATION</b>  | <b>5</b>  |
| 5.1 Steps to remove the pallets.....                                 | 5         |
| 5.2 Recommendations for the installation of your equipment.....      | 5         |
| 5.3 Steps to install two or more equipment MCRU.....                 | 6         |
| 5.4 Specifications for the installation of your condensing unit..... | 7         |
| 5.5 Installation guide for electrical connections.....               | 8         |
| 5.6 Installation of complements.....                                 | 9         |
| <b>OPERATIONS</b>  | <b>10</b> |
| 6.1 Temperature control.....   | 10        |
| 6.2 Folding glass operation.....                                     | 13        |
| <b>MAINTENANCE AND CLEANING</b>                                      | <b>13</b> |
| <b>SOLUTIONS AND EQUIPMENT PROBLEMS</b>                              | <b>14</b> |
| <b>NOTES</b>   | <b>15</b> |
| <b>WARRANTY POLICY</b>   | <b>16</b> |

# IMPORTANT SAFETY INFORMATION

## READ ALL INSTRUCTIONS BEFORE USING

### INTRODUCTION

The next manual covers the information for the installation and operation of the MCRU brand PROKOLD showcases.

It is crucially important that you and others who will operate the equipment read this manual carefully. You can also visit us on our website: [www.torrey.net](http://www.torrey.net) and download more information about this and other models of the PROKOLD family.

### SPECIFICATIONS

| MEAT DISPLAY                                 |                  |                    |                  |                                  |                        |                        |         |            |
|--|------------------|--------------------|------------------|----------------------------------|------------------------|------------------------|---------|------------|
| Exhibition area: 0°C to 8°C (32°F to 46.4°F) |                  |                    |                  |                                  |                        |                        |         |            |
| Storage area: 0°C to -8°C (32°F to 17.6°F)   |                  |                    |                  |                                  |                        |                        |         |            |
| MODEL  | DIMENSIONS       |                    |                  | CAPACITY                         | WEIGHT                 |                        | VOLTAGE | COMP POWER |
|  | HIGH             | WIDTH              | DEPTH            |                                  | NETO <sub>1</sub>      | GROSS <sub>2</sub>     |         |            |
| MCRU52                                       | 53"<br>135 cm    | 51.3"<br>130.30 cm | 44"<br>111.76 cm | 15.89 ft <sup>3</sup><br>450 lts | 211.2 kg<br>757.06 lbs | 249.47 kg<br>550 lbs   | 120V    | 1 HP       |
| MCRU100W                                     | 51.57"<br>131 cm | 98.4"<br>250 cm    | 46.06"<br>117 cm | 23.45 ft <sup>3</sup><br>664 lts | 343.4 kg<br>465.6 lbs  | 381.4 kg<br>839.96 lbs | 120V    | 1 HP       |
| MCRU100WL                                    | 51.57"<br>131 cm | 98.4"<br>250 cm    | 46.06"<br>117 cm | 23.45 ft <sup>3</sup><br>664 lts | 343.4 kg<br>465.6 lbs  | 381.4 kg<br>839.96 lbs | 120V    | 1 HP       |

1. Net weight of the team

2. Weight of the equipment plus packaging and packing

\*Only specifications of MCRU's model

|              |        |
|--------------|--------|
| Refrigerant  | R-404a |
| Liquid line  | 3/8"   |
| Suction line | 1/2"   |
| Hot gas line | 3/8"   |

### WARNINGS



If the voltage is not found within range, it is necessary to install a voltage regulator between the power source and the equipment



Avoid power strips and/or extension cords.



This equipment must not be used by minors or non-qualified personnel



If an assembled piece (non-removable) needs to be removed please contact an authorized service provider.

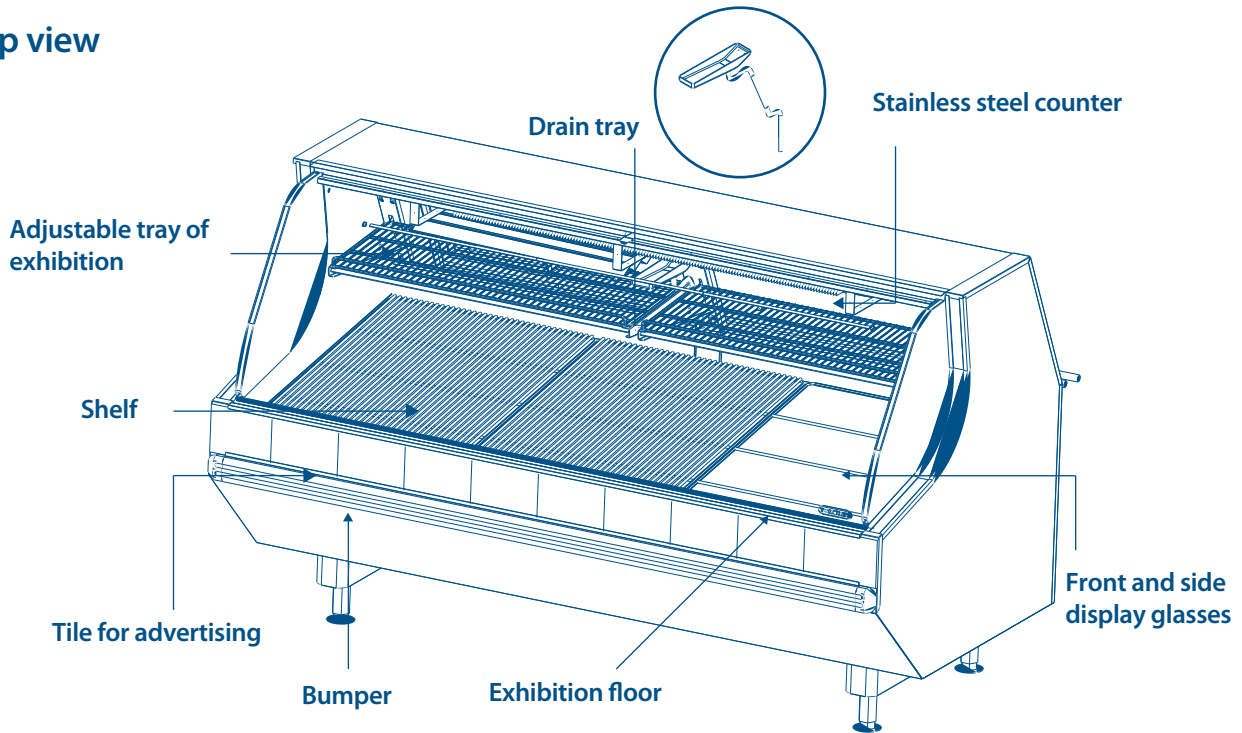
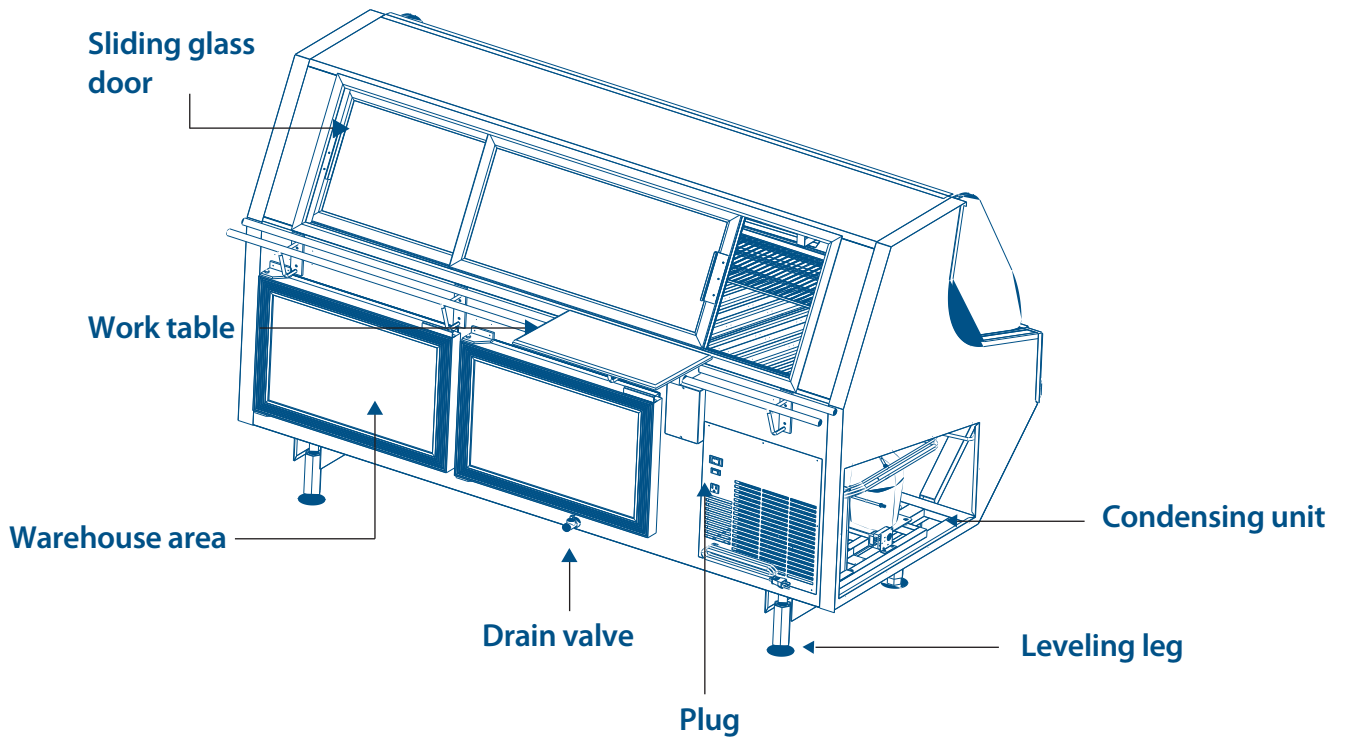

This equipment contains small parts and/or that can cause injuries. Do not allow minors to play inside the equipment.

**KNOWING YOUR EQUIPMENT****Top view****Back view**

\*IMAGES FOR ILLUSTRATION PURPOSES ONLY

## INSTALLATION

### 5.1 Steps to remove the pallet.

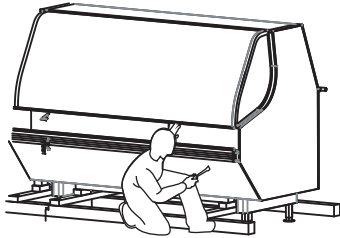

1. Locate the screws and remove them with the screwdriver.

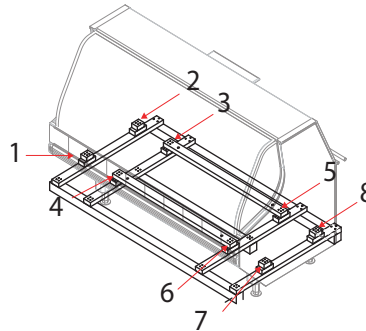

2. Remove the 8 screws that hold the pallet to the showcase at the bottom of it.

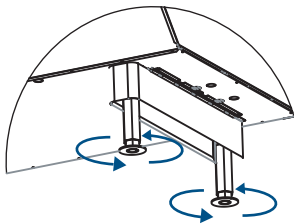

3. Turn the legs to detach them, so that the equipment is supported by the legs instead of the pallet. (Lean with a 1 1/2 " wrench or a perica key)

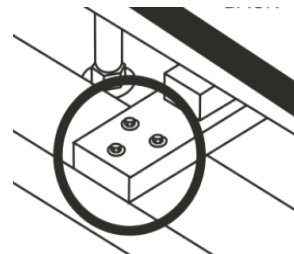

4. Remove the screws that hold the back baluster of the pallet

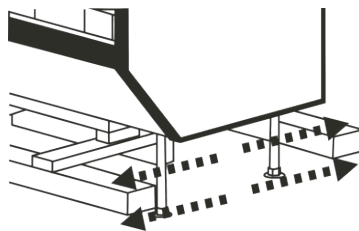

5. Pull the stage as shown in the drawing and your cabinet will be free.

### 5.2 Recommendations for the installation of your equipment



**IMPORTANT!**

It is very important that the showcase is well leveled to ensure a correct drainage

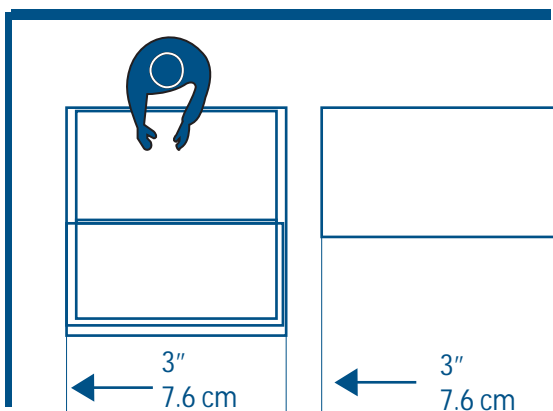

Leave a space between the sides of your equipment and any wall or object.  
We recommend a space of 3 "

\*IMAGES FOR ILLUSTRATION PURPOSES ONLY

## 5.3 Steps to install two or more MCRU's showcases

**1. Remove the side headers of your unit. For this, remove the screws located in the points of union indicated in the following image:**

**Note: remove the tile and the plugs to find some points of union**

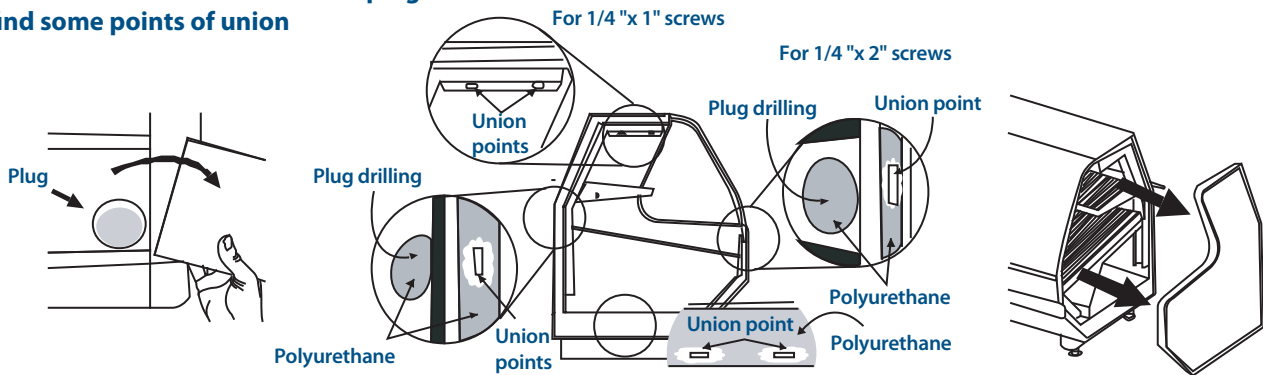

**2. Place double-stick tape and silicone (NSF approved) on the faces of the cabinet of both showcases to be joined to avoid water and air leaks**

1. Front glass
2. Exterior roof
3. Interior roof
4. Exterior backrest
5. Interior backrest
6. Display floor
7. Zipper
8. Interior floor
9. Exterior floor
10. Silicon
11. Double tape of adhesion

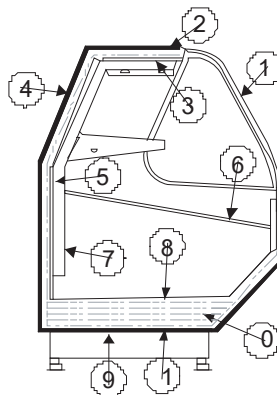

**3. Join both cabinets and adjust the necessary height on the legs to achieve correct leveling and alignment between both.**

**5. Place plugs, gaskets and tiles to finish the union of both showcases, at all times verify that the showcases are level.**

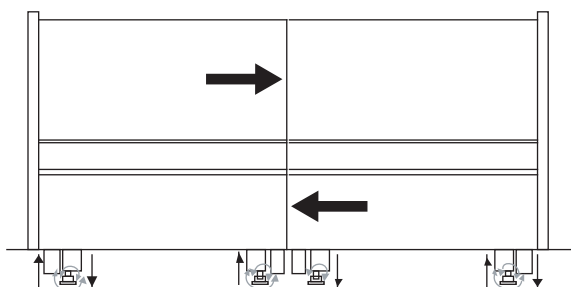

**4. Reattach with the screws giving a continuous tightening at all points so that a joint is made uniformly.**

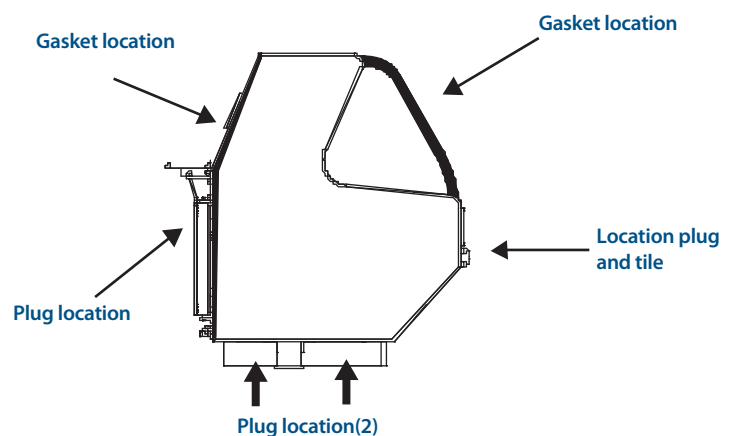

\*IMAGES FOR ILLUSTRATION PURPOSES ONLY

## 5.4 Specifications for installation of your condensing unit (MCRU equipment only)

### Condensing unit (MCRU equipment)

#### 1. Important aspects before installing your condensing unit

##### 1. Important aspects before installing your condensing unit

**A. The capacity of the unit required according to the model is:**  
MCRU100W and MCRU100WL= 1HP  
MCRU52= 1HP

**B. The refrigerator will be R404a except when another one is specified.**

**C. Refrining lines that come out of the showcase:**

Suction 1/2" Ø blue

Line of liquid = 3/8" Ø orange

Hot gas = 3/8" Ø red

**2. When you have found a location for the installation of the condensing unit follow the following recommendations**



**A. The area should be as close as possible to the showcase. For distances greater than 5 meters in height it will be necessary to place an oil separator.**

**B. The area should be well leveled**

**C. The unit must be a minimum of 1 meter from the wall**

**D. The unit must be protected with a weatherproof roof**

**E. If the condensing unit needs to be placed in a completely covered area make sure that the air flows in and out properly (see figure above)**

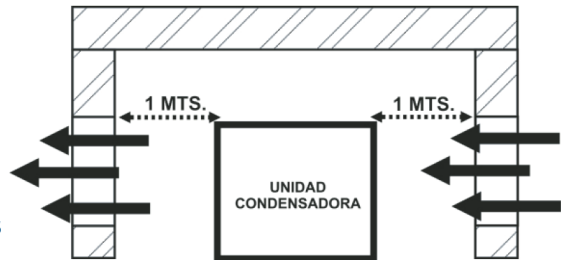

**3. Install a sight glass after the dehydrator filter and before the expansion valve.**

**4. It is advisable to make a trap every 9.8 feet (3mts) from the suction line**

**5. Before turning on the equipment check the oil level, it should be between 1/2" and 3/4" of the indicator level**

**6. The electrical connections of the carver showcase and the condenser are separated. Review the manufacturing guide of the condensing unit for installation procedures.**

**7. Adjustment of the control pressure of the condensing unit, it is necessary depending on the environmental conditions during the installation.**

**8. Before placing product in the unit, turn it on for 24 hours and use the thermometer to check that the temperatures match those indicated**

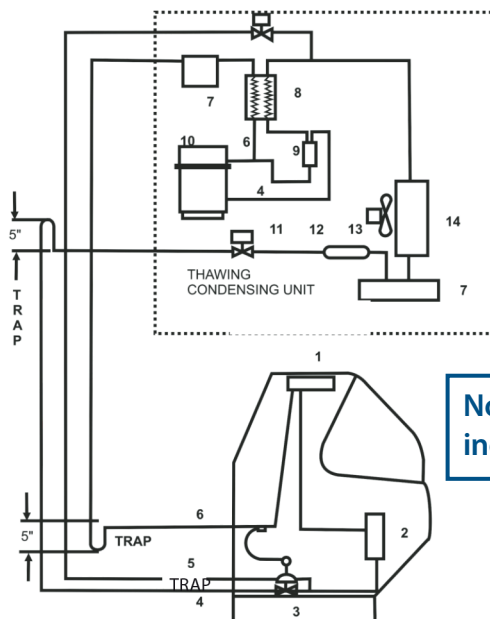

Not necessarily included

1. Superior evaporator
2. Lower evaporator
3. Expansion valve
4. Discharge
5. Melt line
6. Suction
7. Liquid receiver
8. Heat exchanger
9. Oil separator
10. Compressor
11. Solenoid valve
12. Peephole
13. Deshydrator
14. Condenser

**Note:** The condensing units are normally sent only with the suction and the discharge line. For the defrosting line it is necessary to add a third line between the compressor and the condenser input using a type T connection (line 5 of the diagram). The oil separator must go before the defrosting line

## 5.5 Installation guide for electrical connections (Only Stainless MCRU's)

### Connection 115 Vac

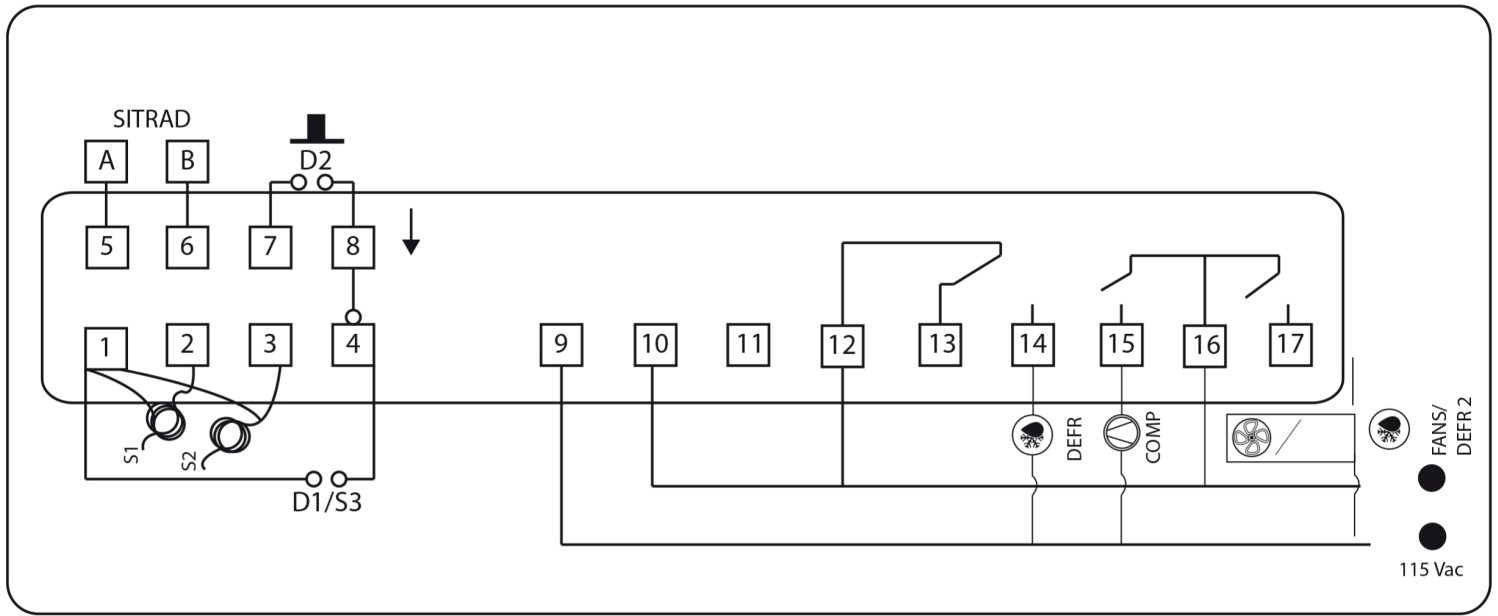

### Connection 230 Vac

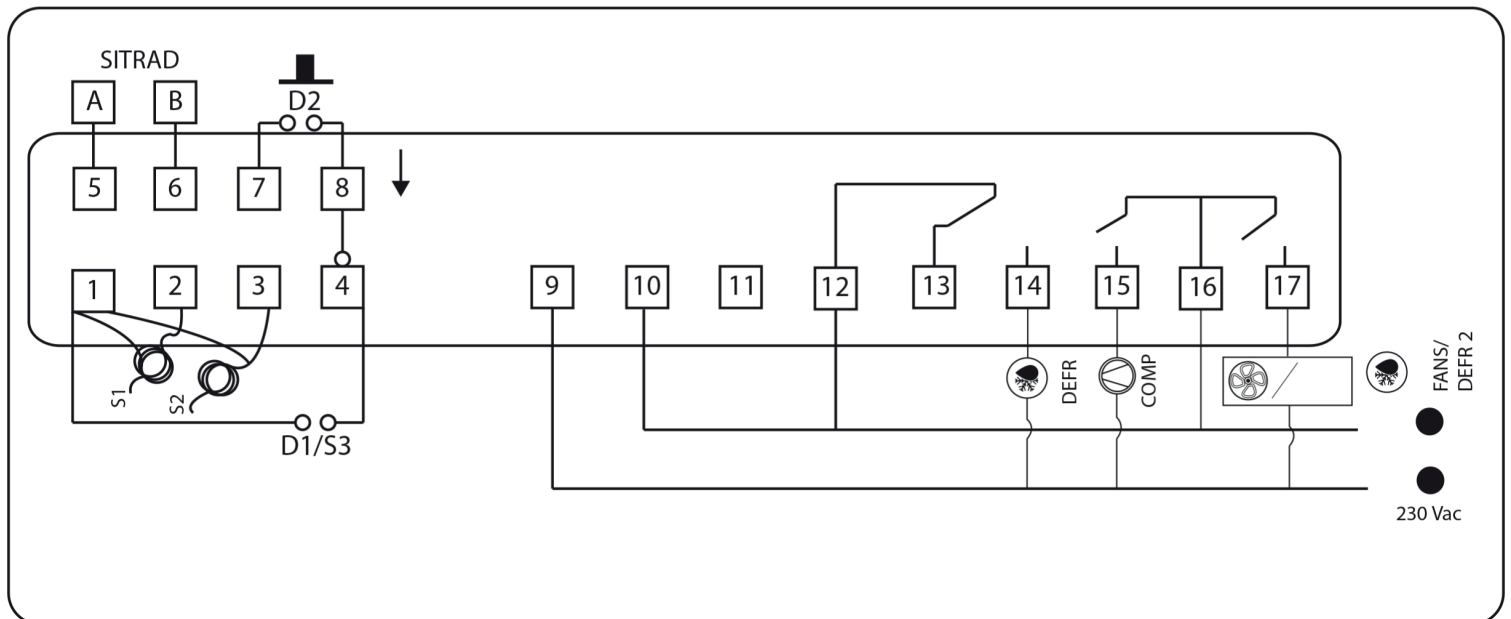

## 5.6 Installation of complements

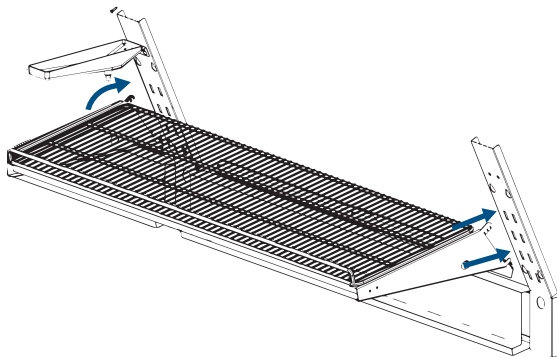

- A** Insert the tabs of the trays into the holes of the zippers

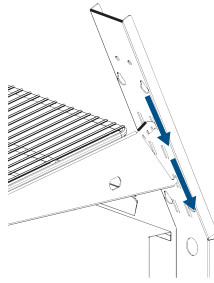

- B** When the tabs are inserted, lower the tray to make it fit

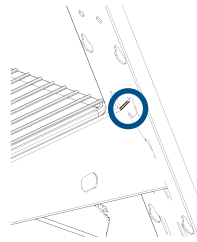

- C** Make sure that all the tabs fit correctly in the zipper.

### Work table

Place the work table in the frame as indicated in the image. Before carrying out the installation, unpack the work table and make a quick visual inspection to ensure that the components are not damaged or in poor condition.

- 1** Verify that the two guides under the work table match the stainless steel tube.
- 2** Secure the work table by pressing towards the tubes

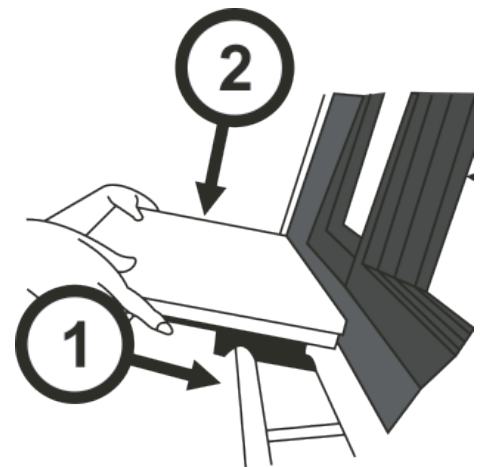

### Sliding doors

The sliding doors come previously installed. If you need to remove them for cleaning, please follow the instructions below

#### Exterior doors

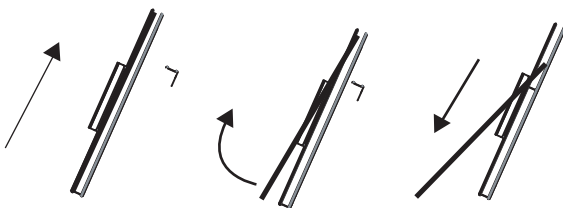

- 1.** Lift the outer door
- 2.** Tilt the door out of the equipment
- 3.** Pull the door out of the equipment

#### Interior doors

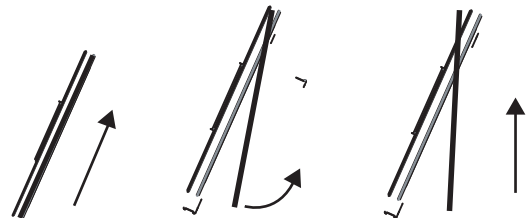

- 1.** Lift the outer door.
- 2.** Tilt the door into the equipment.
- 3.** Pull the door out of the equipment

\*IMAGES FOR ILLUSTRATION PURPOSES ONLY

**OPERATIONS****6.1 Temperature control****Thermostat for MCRU equipment**

For better equipment operation, it is recommended that the thermostat knob does not change the number 5

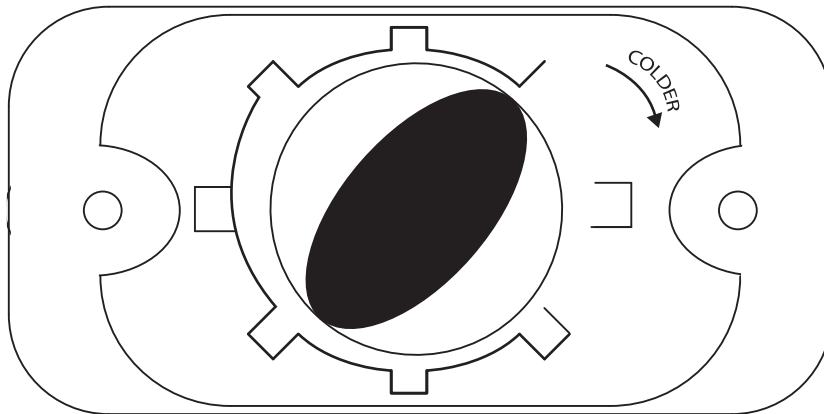
**6.2 Operation of abatible glass (LIFT models only)****Lift the glass**

1. To lift the central glass, always use both hands to hold the center of the glass (considering a 47" separation between both hands)

**Close the glass**

2. To close, do the opening procedure

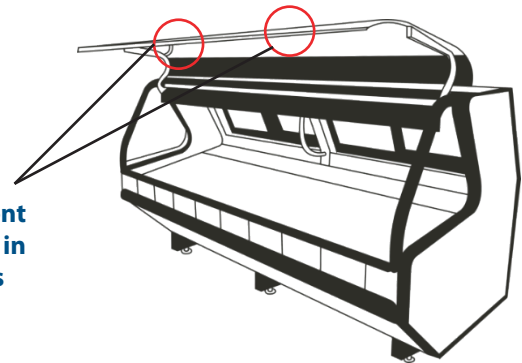

When lifting the front glass, use both hands in the indicated positions

**IMPORTANT!**

Make sure nothing obstructs the movement of the central glass. Clear the entire top area of the display case or work table before lifting the glass

**Note:** It is important to keep the glass raised only as long as necessary, this only to prevent the condensing unit from working too much.

\*IMAGES FOR ILLUSTRATION PURPOSES ONLY

## MAINTENANCE

### Daily maintenance

To clean the front glass, doors and rails use a soft cloth or a paper towel with soap and water. Do not use products with chemical agents and / or any kind

### Weekly maintenance

Drain the butcher showcase using the drain valve located on the back of your equipment. When cleaning the trays, use soap, water and a soft cloth. To clean the display floor you must first remove it and then clean it with water, soap and a cloth. Be sure to check the ammonia gaskets on the rear doors and the rails.

### Monthly maintenance

Clean the upper area of the evaporator and the condenser channels removing any dirt or icing

### Annual maintenance

Check the magnetic packaging

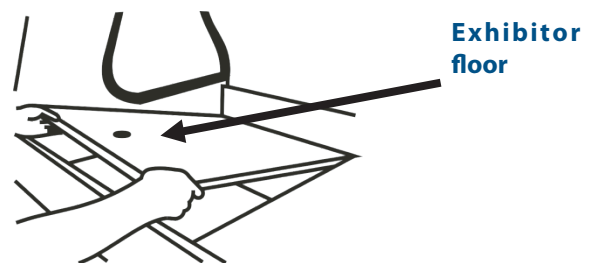
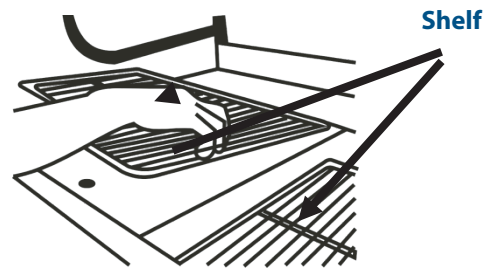

## SOLUTIONS TO TEAM PROBLEMS

Please read the following instructions before calling your technician in case of any problem with the equipment

| SYMPTOMS   | CAUSE  | DESCRIPTIONS   |
|--|--|--|
| The equipment in not working                                   | Connection issues  | Check that the plug is correctly plugged in and that it does not show any wire damage  |
| The equipment in not cooling properly                          | Poor operating conditions<br>Many door openings frequent changes of temperature set point.<br>The unit is too close to the stove or oven.<br>The unit contains a lot of product. | Plan the entrances and exits of the product inside the unit<br>Change the location of the equipment<br>Improve the accommodation of the product, eliminate big bags and packing and leave open space for airflow |
| Leakage excess or condensation on the outside of the equipment | Extreme humidity in the enviroment (rain) or coastal area.   | Regularly clean the affected areas, if possible, install a dehumidifier.   |
| Condensation or ice formation on the inside of the equipment   | The doors open frequently<br>The door does not shut correctly<br>A defrosting cylice just occurred   | Plan the entrances and exits of the products inside the unit<br>Replace the magnetic seal of the door<br>It is not necessary to do anything. This is a periodic process for its proper operation.                |
| The equipment is leaking water                                 | The holes where the harness goes out and the pipe have no seal.<br>The hose of the tray of the diffuser is obstructed or clogged.  | Apply silicone and/or polyurethane.<br>Correctly adjust the hose or replace it with a new one  |

**NOTES**

**WARRANTY POLICY****LIMITED WARRANTY STATEMENT****1 Year Parts/Labor Warranty**

Prokold Refrigeration, Inc. (hereafter "Pro kold") warrants to the original purchaser of every new Pro kold refrigerated unit (including the cabinet and all parts thereof) (hereafter "Unit") to be free from defects in material or workmanship. The Unit is a commercial Unit intended for commercial and/or industrial use only by trained and qualified personnel. Buyer assumes any and all responsibility for assuring that the Unit is used only by trained and qualified personnel. This Limited Warranty is enforceable only by the original purchaser of the Unit from an authorized Pro kold distributor and may not be enforced by any subsequent purchaser. Further, this limited warranty only covers defects in material or workmanship that arise (1) after proper installation and start-up in accordance with the instruction packet supplied by Pro kold with the Unit; (2) if proper maintenance is performed as specified by Pro kold in its instruction packet and (3) as long as the Unit is subjected only to normal and proper use as provided for in the instruction packet supplied with each Pro kold Unit.

Pro kold's obligation under this warranty is limited to a period of one (1) year from the date of original purchase or fifteen (15) months after shipment date from Pro kold, whichever occurs first.

The sole obligation of Pro kold under this warranty is limited to repair or replacement, including labor charges, of the defective parts, assemblies or unit at Pro kold's sole discretion. The labor warranty shall include (1) standard straight time labor charges only and (2) "reasonable" travel time. "Reasonable" travel time shall be determined by Pro kold on a case-by-case basis.

**WARRANTY CLAIM PROCEDURE**

All claims for labor or parts must be made directly to Pro kold. All claims shall include: (1) model number of the unit; (2) the serial number of the cabinet; (3) proof of purchase; (4) and all pertinent information supporting the existence of the alleged defect. In case of warranty compressor, Pro kold y will either request the compressor or compressor tag be returned to Pro kold y along with above listed information.

Any action for breach of these warranty provisions must be commenced within one (1) year after the cause of the action has occurred.

The product should be delivered in its original packaging or in a packaging affording an equal degree of protection.

Transportation and insurance charges to and from the Pro kold service center, if needed, are not included in this warranty.

**ADDITIONAL FOUR YEAR COMPRESSOR WARRANTY**

In addition to the one (1) year warranty stated above, Pro kold also warrants its hermetically sealed compressor to be free from defects in both material and workmanship under normal and proper use and maintenance service for a period of four (4) years from the date of original purchase but not to exceed 5 (five) years and three (3) months after shipment from the manufacturer. The compressor warranty is subject to any and all of the conditions, prerequisites and limitations of the one (1) year warranty listed above.

Compressors determined by Pro kold to have been defective within this extended time period will, at Pro kold's option, be either repaired or replaced with a compressor or compressor parts of similar design and capacity.

The four (4) year extended compressor warranty applies only to hermetically sealed parts of the compressor and does not apply to any other parts or components, included, but not limited to, cabinet, paint finish, temperature control, refrigerant, metering device, driers, motor starting equipment, fan assembly, heaters, fan assembly or any other electrical component, etcetera.

#### **404A/134A COMPRESSOR WARRANTY**

The four (4) year compressor warranty detailed above will be voided if the following procedure is not strictly adhered to:

1-This system contains R404A, R22 or R134A refrigerant and Polyol ester lubricant. The Polyol ester lubricant has rapid moisture absorbing qualities. If long exposure to the ambient conditions occurs, the lubricant must be removed and replaced with new lubricant. For oil amounts and specifications please call Pro koldTechnical Support Department (713-691 1195). Failure to strictly comply with recommended lubricant specification voids the compressor warranty.

2-Drier replacement is very important and must be changed when a system is opened for servicing. A drier using XH-7 desiccant or an exact replacement solid core drier must be used. The new drier must also be the same capacity as the drier being replaced. Failure to strictly comply with this direction voids the compressor warranty.

3-Micron level vacuums must be achieved to insure low moisture levels in the system. 500 microns or lower must be obtained.

4-Compressor must be obtained through Pro kold, unless otherwise specified in writing through Pro kold Technical Support Department.

#### **WHAT IS NOT COVERED BY THIS WARRANTY**

THIS EXPRESS LIMITED WARRANTY IS THE SOLE AND EXCLUSIVE WARRANTY MADE BY PROKOLD REGARDING THE UNIT AT ISSUE. ALL OTHER WARRANTIES, WHETHER STATUTORY, ORAL, EXPRESS OR IMPLIED, ARE EXPRESSLY DISCLAIMED, INCLUDING BUT NOT LIMITED TO THE IMPLIED WARRANTY OF MERCHANTABILITY AND IMPLIED WARRANTY OF FITNESS FOR A PARTICULAR PURPOSE.

As provided above, Pro kold's sole obligation under this warranty is limited to either repair or replace parts or unit at Pro kold's discretion, subject to the additional limitations below.

This warranty neither assumes nor authorizes any person to assume obligations other than those expressly covered by this warranty.

-WEAR PARTS: This warranty does not cover wear parts, which due to the nature of the machine, have limited usable life and have to be replaced on a use and wear basis.

-PERIODIC MAINTENANCE: Periodic and Recommended Maintenance of the equipment including, but not limited lost parts, misuse and abuse, adjustments, improper installation, and normal wear are not covered under this warranty.

-NO SPECIAL, INCIDENTAL OR CONSEQUENTIAL DAMAGES: Pro kold is not responsible for any economic loss, including but not limited to: special, incidental or consequential damages (see Limitation of Liability section) whether or not on account of scale failure.

-WARRANTY IS NOT TRANSFERABLE: This warranty is not assignable and applies only in favor of the original purchaser/user to whom delivered. Any such assignment or transfer shall void the warranties herein made and shall void all warranties, express or implied, including any warranty of merchantability or fitness for a particular purpose.

-IMPROPER USAGE: Pro kold assumes no liability for parts or labor coverage for component failure or other damages resulting from improper usage or installation or failure to clean and/or maintain Unit as set forth in the warranty packet provided with the unit.

-ALTERATION, NEGLECT, ABUSE, MISUSE, ACCIDENT, DAMAGE DURING TRANSIT OR INSTALLATION, FIRE, FLOOD, ACTS OF GOD. Pro kold is not responsible for the repair or replacement of any parts that Pro kold determines have been subjected after the date of manufacture to alteration, neglect, abuse, misuse, accident, damage during transit or installation, fire, flood, or act of God.

-PREVIOUS REPAIR. Pro kold shall not be responsible under this Warranty if the Unit has been previously repaired by someone other than Prokold or Warrantor's authorized service personnel.

-IMPROPER ELECTRICAL CONNECTIONS. Pro kold is not responsible for the repair or replacement of failed or damaged components resulting from electrical power failure, the use of extension cords, low voltage, voltage drops to the unit.

-NO IMPLIED WARRANTY OF MERCHANTABILITY OR FITNESS FOR A PARTICULAR PURPOSE: This warranty is exclusive and in lieu of all other warranties, including but not limited to the implied warranty of merchantability and the implied warranty of fitness for a particular purpose. There are no warranties which extend beyond the description on the face hereof.

#### **REGULATORY LAWS AND/OR STANDARDS**

The performance of the parties hereto is subject to the laws of the United States. The company takes reasonable steps to keep its Units in conformity with various nationally recognized standards and such regulations which may affect its Units. However, the company recognizes that its Units are utilized in many regulated applications and that from time to time standards and regulations are in conflict with each other. Pro kold makes no promise or representation that its Unit will conform to any federal, state or local laws, ordinances, regulations, codes or standards except as particularly specified and agreed upon in writing as a part of the contract between The Buyer and Pro kold. Pro kold prices do not include the cost of any related inspections or permits or inspections fees.

**OUTSIDE U.S. and CANADA:** This warranty does not apply to, and Pro kold is not responsible for, any warranty claims made on Units sold or used outside the United States or Canada.

#### **LIMITATION OF LIABILITY:**

Buyer's remedies set forth in this Limited Warranty are exclusive and Pro kold's aggregate liability for any claim of any kind for any loss or damage resulting from, arising out of, or connected with the performance of the Unit or from the manufacture, sale, delivery, resale, repair or use of the Unit whether based on contract, statute, warranty, tort (including but not limited to negligence), fault, strict liability, indemnity, or otherwise shall in no event exceed the price allocable to the Unit which gave rise to the claim. In no event shall Pro kold be liable to the Buyer for special, incidental or consequential damages of any kind or nature including, but not limited to: recovery of monetary damages, loss of profits or revenue or business opportunity, loss by reason of shutdown of facilities or inability to operate at full capacity, cost of obtaining replacement equipment, cost of cover or cost to other damaged equipment or property, and repair, replacement, and/or restoration of any materials, equipment, property, or work furnished by anyone other than Pro kold even if it is necessary to repair, replace, restore, remove, damage, and/or otherwise affect such materials, equipment, property, or work in order to complete repairs, replacement, and/or restoration of those furnished by Warrantor.

Pro kold's limited liability under this Limited Warranty is valid and enforceable even if the limited remedy provided in this Limited Warranty is determined to have failed of its essential purpose



PRO-KOLD USA

1293 N. Post Oak Road  
Suite 100, Houston, TX 77055

AMER ICA

EUROPE

ASIA

AFRICA

OCEANIA

[www.pro-kold.net](http://www.pro-kold.net)